

Roller burnishing tool type WIK / WAK / WPF

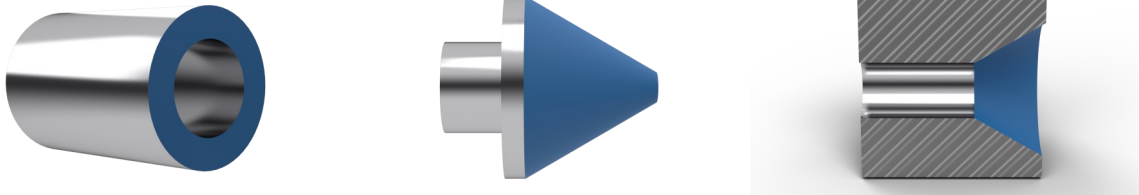

Application :



General information:

Tool Body	Diameter Range	Shank		Dimension			
		Morse Taper	Cylindrical	a	b	c	e
WIK 1	006 - 004	MK2	Ø20 h6 x 50	78,5	65,0	25,0	depending on the workpiece
WIK 2	045 - 090	MK3	Ø25 h6 x 56	98,0	92,0	48,0	
WIK 3	100 - 149	MK4	Ø32 h6 x 60	123,0	107,0	63,0	

All dimension in mm

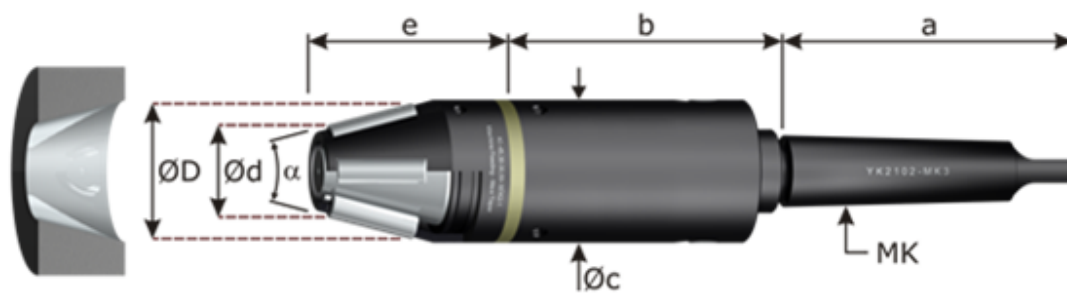

Tool Body	Diameter Range	Shank		Dimension				
		Morse Taper	Cylindrical	b	c	h	i	e
WAK 1	006 - 004	MK2	Ø20 h6 x 50	65,0	25,0	50,0	20,0	depending on the workpiece
WAK 2	045 - 090	MK3	Ø25 h6 x 56	92,0	48,0	56,0	25,0	
WAK 3	100 - 149	MK4	Ø32 h6 x 60	107,0	63,0	60,0	32,0	

All dimension in mm

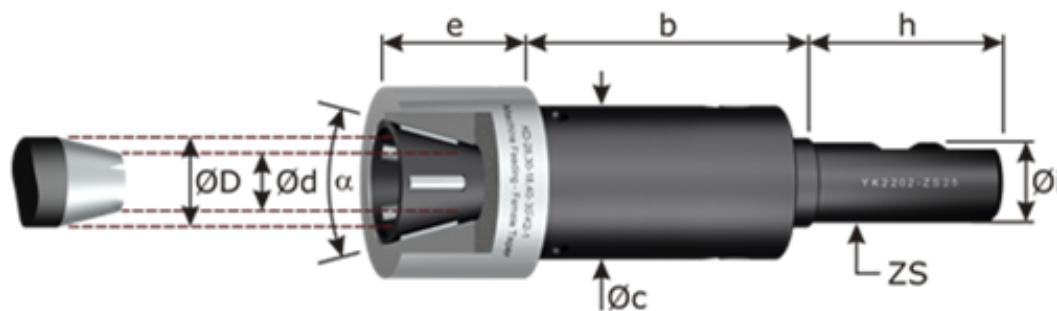

Tool Body	Diameter Range	Shank		Dimension				
		Morse Taper	Cylindrical	b	c	h	i	e
WPF 1	006 - 004	MK2	Ø20 h6 x 50	65,0	25,0	50,0	20,0	depending on the workpiece
WPF 2	045 - 090	MK3	Ø25 h6 x 56	92,0	48,0	56,0	25,0	
WPF 3	100 - 149	MK4	Ø32 h6 x 60	107,0	63,0	60,0	32,0	

All dimension in mm

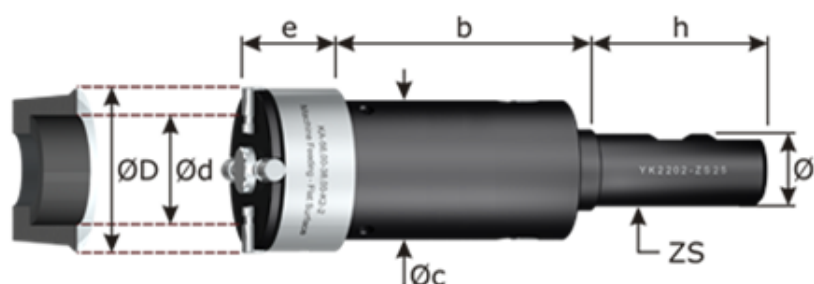



Roller burnishing tool type WIK / WAK / WPF

Machining parameter:

Tool type	Revolution [1/min]	Pre-machining roughness
WAK / WIK / WPF	200 - 700	Rz = 5 - 15 μm